

1 2 3 4 5 6

A

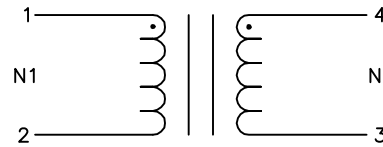
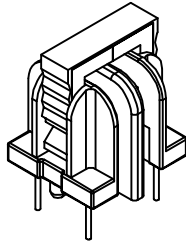
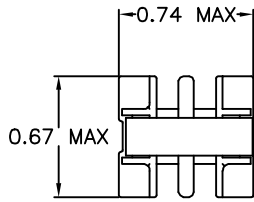

B

C

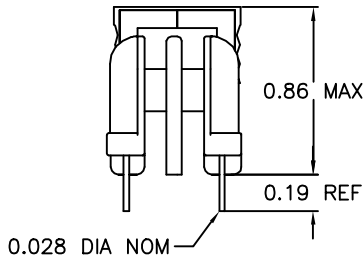

D

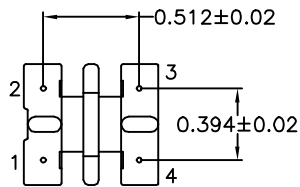

E

ELECTRICAL SPECIFICATIONS

- L @ 1kHz .1V - (1-2) 5mH MIN
- LL @ 100kHz .1V - (1-2) 136μH TYP
(WITH 3&4 SHORTED)
- CC @ 100kHz .1V - (1-4) 3.5pF TYP
- URNS RATIO - ±3%
N1:N2 - 1:1
- DCR - OHMS TYP, TOL TBD
N1 - 0.787
N2 - 0.787
- HIPOT - 2500VAC 1MIN OR 3000VAC 1SEC
N1 TO N2

F

G

CRAMER RESERVES THE RIGHT TO CHANGE TOLERANCE ON PARASITIC PARAMETERS

H

REVISION		DATE	MARKINGS 544-EIA DATE CODE CC 105-050	LOCATION TOP OF CLIP	
A	RELEASED	05/21/99	DESCRIPTION 0.5 AMP 5 MILLIHENRY COMMON MODE CHOKE	TOLERANCE UNLESS OTHERWISE SPECIFIED 2 PLACE DECIMALS ±0.010 3 PLACE DECIMALS ±0.005 FRACTIONS ±1/64 ANGLES ±1/2°	PROPRIETARY INFORMATION PROPERTY OF CRAMER COIL & TRANSFORMER CO. DUPLICATION AND/OR DISTRIBUTION BY PERMISSION ONLY
B	UPDATED LL, CC, N2 DCR & HIPOT	06/18/99			
CUSTOMER					
PAGE 1 OF 1					
G:\DATA\SPECS\ENG\CC\105-050			CUSTOMER PART NUMBER		REV
DR. NJW			DATE 05/21/99		CRAMER PART NUMBER CC 105-050
APPD. JDB			DATE 05/21/99		

I

J

1 2 3 4 5 6