

1

2

3

4

5

6

A

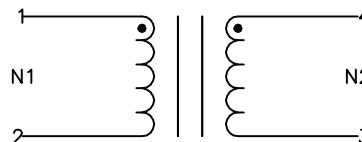
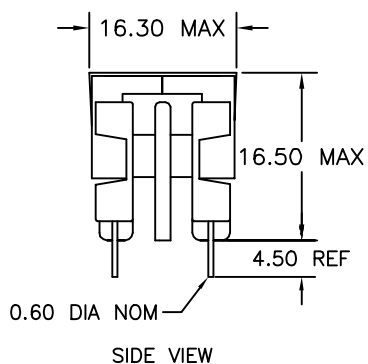

A

B

B

C

C

D

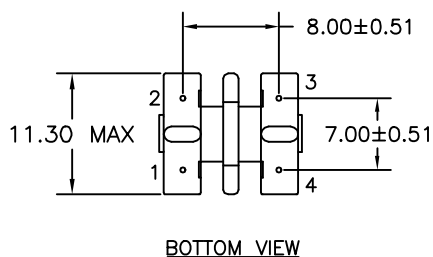

D

E

E

#### ELECTRICAL SPECIFICATIONS

L @ 10kHz .1V - (1-2) 45mH MIN

LL @ 100kHz 10mA - (1-2) 490μH MAX  
(WITH 3&4 SHORTED)

CC @ 100kHz .1V - (1-4) 6.5pF MAX

URNS RATIO - ±3%  
N1:N2 - 1:1

DCR - OHMS MAX  
N1 - 4.42  
N2 - 4.42

HIPOT - 2500VAC 1MIN OR 3000VAC 1SEC  
N1 TO N2

F

G

G

H

H

REVISION		DATE	MARKINGS	LOCATION
A	RELEASED	10/15/04	544202450	TOP OF CLIP
B	ASSIGN LL, CC & DCR MAX'S, INSERT NEW BOBBIN VIEWS ECO#5694	01/26/06	DESCRIPTION 0.15 A 45 MILLIHENRY C.M. CHOKE	TOLERANCE UNLESS OTHERWISE SPECIFIED 2 PLACE DECIMALS ±.010 3 PLACE DECIMALS ±.005 FRACTIONS ±1/64 ANGLES ±1/2°
			CUSTOMER	PROPRIETARY INFORMATION PROPERTY OF CRAMER COIL & TRANSFORMER CO. DUPLICATION AND/OR DISTRIBUTION BY PERMISSION ONLY
			G:\DATA\SPECS\ENG\CC\202-450	CUSTOMER PART NUMBER
			DR. MEC	DATE 10/15/04
			APPD. MJA	DATE 10/15/04
				REV
				CRAMER PART NUMBER
				CC 202-450
				REV B

I

J

J

1

2

3

4

5

6